



# Duress and Emergency Notification System

TLS Encryption, Supervision + Monthly Testing



Wireless and PoE Duress Buttons

Operates logged off/locked  
Also available for Laptops



Lynx Alerts can include RTSP IP video



Group and Emergency Notification  
Windows and MAC LynxIcons



**LOCKDOWN. Morris Building**

**NEW**

Popup alerts on PCs when logged off/locked.

## The Lynx System can take the human element out of communication



Integrate existing alarms and automate communication  
Even add microphones to detect Aggressive Behavior

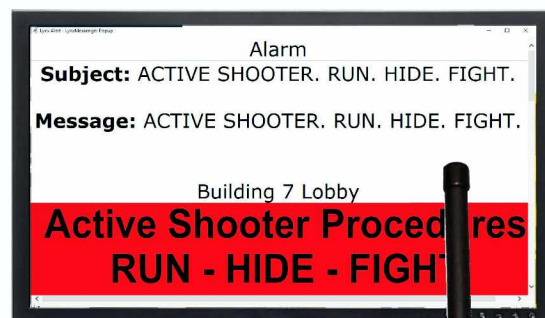

# The LynxGuide Duress and Instant Alert System



The Lynx System is now in its 15th year and the areas we have been improving are encryption, testing, supervision of alarms and scalability. Many facilities have added the emergency notification elements of the Lynx system to improve communication as they realized the limits of SMS text and email solutions.

The test feature in the LynxClient software for the Icons, Keyboard, USB PC duress buttons, network hardwired and wireless duress buttons, has been well received by our customers. The test enables employees to test the alarm once a month, creating reports, building confidence for employees and confirming the location. This is one of the many reasons over 120 VA Medical Centers and 100's of other organizations are using the Lynx System.

Activation can be from existing systems such as Shooter Detection Systems, C-CURE9000, our API or activated by secure LynxIconPro from desktops or mobile devices. A new output option for Lynx is the new Axis IP Speakers - using text to speech or pre-recorded messages to communicate to targeted location or locations that do not have a PA System.

**I am often asked what makes Lynx different from other solutions here are a few:**

**Single Integrated Solution manufactured and supported in the USA**  
**PC Based Duress F9-F11 or USB that operate logged off or locked**  
**TLS 1.2 Encryption and Full Supervision of all software and hardware**  
**PC Popup Alert can occur when logged on, off or locked**  
**IP Video in PC Popup Alerts using RTSP**

Sincerely,

**Timothy J. Lee**

VP, National Sales

**1819 Firman Drive #137 Richardson, TX 75081**  
**Sales (972) 231-6874 Ext 129 [TIM.LEE@MITSI.COM](mailto:TIM.LEE@MITSI.COM)**

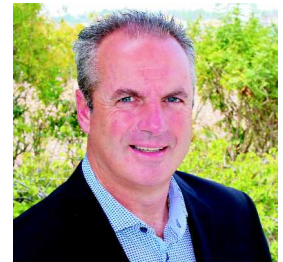

**Timothy Lee**  
**VP, Sales**

## Lynx System Features

### Lynx Software and Hardware Security - Full Encryption

Lynx supports encryption of all data transfer over the LAN and WAN.  
Software and Hardware supports TLS 1.2 protocol for communication to the LynxGuide server.  
Web interface supports HTTPS for configuration, management and report generating.

### LynxClient Software Features

Lynxclient software is supervised and has a built-in Test Feature for computers.  
LynxIcons can be activated instantly or pending allowing additional text and images to be added.  
LynxMessenger Popup alerts can be 100%, 70% or 30% of the screen or scroll across the top or bottom.  
LynxMessengerPro Popup alerts operate even when the PC is logged off or locked (Text only).

### Lynx System Hardware Features

LynxDispatcher communicates to existing facility radios via text to speech or pre-recorded wave files.  
LynxPA communicates to existing overhead PA systems via text to speech or pre-recorded wave files.  
LynxNetMessenger sends alerts that override HDMI content on existing or new HDMI monitors.  
Axis PoE Speaker integration is supervised and supports text to speech with confirmation report.  
LynxNetO series relay output devices can tie into existing access control or any other systems.

### Other Lynx System Features

A single alarm activation can communicate multiple messages/procedures based upon location or role.  
IP camera feeds, using Real Time Streaming Protocol, can be included in LynxMessenger Popup alerts.  
Lynx offers a API using https to communicate with other systems.  
Activate Lynx alarms from other systems using RSS feeds (NOAA, etc.) and/or Email (camera system, etc.).  
Automatic shooter detection notifications are available with Shooter Detection Systems partnership.  
Integrations with Software House C-CURE9000, Gentec, Kantech, Sound Intelligence, Axis  
Communications to automate communication from alarms or into systems.



Manufactured  
and supported  
in the USA



Available  
on GSA

**For an Online Lynx Demonstration contact Tim Lee**  
**(972) 231-6874 ext 129 [TIM.LEE@MITSI.COM](mailto:TIM.LEE@MITSI.COM)**



# Lynx System Overview

## INPUTS Included with LynxGuide Server

**Supervised LynxIconPro for PCs & MACs, Mobile Devices**  
Emergency Notifications. 10 Included

**Supervised LynxIcons for PCs & MACs**  
Assistance Notifications

**LynxKey Client Software**  
PC or VDI  
Keyboard Alarms operate logged on

**LynxKeyPro Client Software**  
PC Keyboard Alarms operate logged on or off  
100 seats included

Email

RSS Feed Input



USB Duress Buttons

C-CURE 9000 events

Application Program Interface. REST Json

## INPUTS Lynx System Options

Active Shooter Detection System

POE Panic Buttons

Connect to New or Existing Alarms

Wireless Alarms to The Monitor

Wireless Alarms

**Lynx**  
Systems

**LynxGuide Server**



**LynxMessenger Client Software**  
PC and Mac

RTSP IP Camera Integration

200 Text SMS Messages per Month

Text Pagers

Email

RSS Server

**LynxMessengerPro**  
Allows text popups on PCs when they are Logged off or locked  
10 Included

The LynxGuide Server is offered on a turn-key server or as software only to install on you own physical or virtual server. 100 - 20,000 server seats configurations offered. Each LynxClient Software function or LynxNet device counts as 1 server seat. **One computer with LynxClient installed can use 1-4 server seats, depending on what LynxClient functions are enabled.**

LynxGuide Standard software licensing allows for a server to operate on a LAN covering a single campus or facility, (including remote offices with less than 100 PCs within the county). Enterprise multi-site solution license is available.

Compatible with Windows 7, 8 & 10 and Macs

C-CURE 9000 events

Audio to Phones  
Text to Phones

Audio to Existing IP Phone Systems

Audio to Existing Radio Systems

Application Program Interface. REST json

Axis POE Speakers Interface Indoor/Outdoor/Ceiling

Audio to Existing PA Systems - Line Level

Output Relays to activate Existing Systems

LED Display

HDMI Monitor Interface

Strobes and Visual Outputs

## OUTPUTS Included with LynxGuide Server

## OUTPUTS Lynx System Options

The LynxClient multi-function software allows PCs and Macs to send alarms and receive notifications via an encrypted protocol from the LynxGuide server. The LynxClient software uses an MSI installer that can be loaded on any Windows based PC manually, or deployed using software distribution tools. It may be deployed with any combination of features enabled or in a dormant mode, to be enabled when needed. The LynxClient software can be configured to be LynxIcon, LynxKey, LynxKeyPro, LynxUSB, LynxMessenger or LynxMessengerPro. All LynxClient software functions can be enabled or disabled from the LynxGuide server web interface. The system tray icon will indicate what LynxClient functions are enabled on a client PC.

**One computer with LynxClient installed can use 1-4 server seats, depending on what LynxClient functions are enabled.**



System Tray Icon

## LynxIcon - Assistance Notifications

See Something.  
Say Something.



Medical Assist  
Needed



The **LynxIcon** client software function provides **Assistance Notification** Icons that are ideal for non duress events such as Medical Assistance, Supervisor Needed, etc. The LynxIcon can send instantly or pending, so the user can add additional information before sending the notification. The LynxIcons are easily accessed from the user's PC or MAC and are fully configurable from the LynxGuide server. The LynxIcon is included in the monthly test and enables confirmation of the computer location. **Uses one server seat per computer.**

## LynxIconPro - Emergency Management

Lock Down

Active Shooter



Activate from Mobile Devices  
on your WiFi with access  
to the LynxGuide Server

The **LynxIconPro** function is designed for key **Emergency Managers**, who have the authority to activate facility wide alerts, notifications and situational events such as Lockdown, Shelter In Place, Active Shooter. The LynxIconPro icons are pre-configurable and are accessible by logging into their accounts on the LynxGuide server web interface from any device with a web browser that can access the LynxGuide server.

**The LynxGuide server includes 10 Client License seats**

**LYNX-ICONPRO** 10 LynxIconPro Client License seats

## LynxKeyPro - Duress Alarm - operates when logged ON or OFF



LynxKeyPro is a two key  
alarm combination

The **LynxKeyPro** client software function provides a 2 key combination keyboard duress alarm, that allows users to send messages from a PC when logged ON, logged OFF or LOCKED. A two key combination such as F9-F11 or F1-F12 sends alarms to the LynxGuide Server (20 combinations available). Red "PANIC" labels are included for marking the keyboard. The LynxGuide server includes a starter pack of LynxKeyPro, more may be added. Up to 3 key combinations may be configured for different issues.

**The Employee Test and Location Verification makes managing LynxKeyPro simple and improves employee confidence. Page 5.**

 **Supervised**

**Add more LynxKeyPro**

**LYNX-KEYPRO** 25 LynxKeyPro Client License Seats includes 50 Red 'PANIC' labels



**The New laptop location feature** for the LynxKeyPro software, prompts employees when the LynxClient software detects a possible change of location. The employee is asked to confirm their new location.

# Input - LynxKey and Monthly Test Feature

## LynxKey - Duress Alarm - operates when logged ON

The **LynxKey** client software function provides a 2 key combination keyboard duress alarm, that allows users to send messages from a PC or VDI keyboard when the user is logged on. **Labels for Keyboard keys are optional**

**Supported VDIs:** Citrix XenDesktop Citrix XenApp VMware Horizon View  
(5.0 and higher)



## RSS Reader and RSS Server

The LynxGuide server has a built-in RSS Feed Reader and RSS Feed Server. The RSS feed reader allows feeds such as NOAA, County or Industry Alerts to activate alarms within the Lynx system. The RSS Feed Server allows any alarm channel or alarm group to send RSS feeds. RSS readers that have been configured to the Lynx RSS feeds will receive the messages.



## LynxClient Test Feature

### LynxIcon, LynxKey, LynxKeyPro, LynxUSB Duress Buttons

The LynxClient software is supervised and has a built in test feature. The Windows or Mac based LynxIcons can be tested on a monthly basis, confirming functionality and the location of the computer. The monthly test educates end user on proper use of the Duress function. When logged in, the employee will be prompted to test the alarm. The key combination or USB button will be temporarily de-activate while they go through the 30 second test.



The Locking version of the USB duress button has a test feature that can be performed by an officer with the reset key.

The PC will show the employee how to correctly tested the alarm and this information will be recorded in the test report. The report will also show any PCs not tested within the test period.



**A test of your LynxClient software is required.**

Your Lynx duress alarms will be disabled during the test.  
Contact your facility's Lynx administrator for any test related issues.

Test now

Remind me again in 3 hours

LynxClient Testing Wizard

Test Keyboard Alarms  
F9 + F11  
Test Duress Button  
LynxUSB Button  
Test LynxIcons  
LynxIcon Panel  
Verify Location  
Finish

Press both indicated keys at the same time.  
Then immediately release them.



00:18



LynxClient Testing Wizard

Test Keyboard Alarms  
F9 + F11  
Test Duress Button  
LynxUSB Button  
Test LynxIcons  
LynxIcon Panel  
Verify Location  
Finish

The LynxUSB button has been detected.  
Press the button now to continue the test.



Press the button

00:16



Popup on employee PC asks employee to test Lynx

PC screen walks employee through the process

The optional Location Verification test prompts the employee to confirm the PC location. If the location is incorrect, the employee can enter the correct information and their telephone extension number. The Location reports allow the Lynx system administrator to verify the reported location change, format the message and update the location information in the Lynx system.



# Output - LynxMessenger PC Popup/Banner Alerts

## LynxMessenger

## "Popup" Alerts



Lynx Popup Alerts can include IP cameras using RTSP



Supervised



System Tray Icon

**LynxMessenger Popups are a powerful communication tool, allowing alerts to be sent to PCs and Macs on your network. Popups will appear on the display, on top of what the user is working on, notifying them immediately.**

The **LynxMessenger** client software function is a simple-to-use instant notification program. The LynxClient software uses an msi installer that can be loaded on any Windows based device. LynxClient can be installed manually or deployed using software distribution tools. The software can also be deployed in a dormant mode to all PCs/Macs, allowing system administrators to enable any LynxClient function when needed. **The Lynx popup is NOT blocked by system popup blockers.** Alerts can be sent to individuals, facility-wide or area specific groups for notification issues. The LynxGuide system supports 100 - 20,000 server seats.

**One computer with LynxClient installed can use 1-4 server seats, depending on what LynxClient functions are enabled.**

### **LynxMessenger Popup Alarms can include:**

JPG, BMP, PNG, GIF images - such as procedures, maps or photos  
PDF files - documents, Word documents, Excel spreadsheets  
Link to IP Video cameras (RTSP) or web sites for weather alerts, City or County issues.  
Message Log records all events  
Alarms can be configured to go straight out or go to pending to add additional information  
Associate a sound file or Text to speech on the PCs/Macs receiving the alert

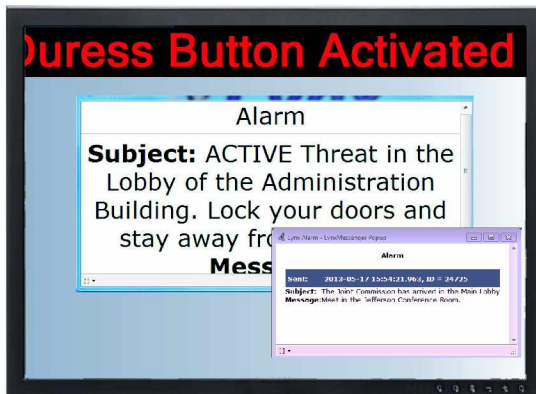

The **LynxMessenger** "Popup" can take over the whole screen or be a scrolling message at the Top, Bottom or Middle of the screen appearing on top of what employees are working on. Each Alarm can be custom configured based on codes and other issues. The **LynxMessenger** "Popup" can take over 100% of the screen, 70% screen, 30% screen or a scrolling message bar.

**NEW**

## Optional PC LynxMessengerPro operates logged off or locked

The LynxMessengerPro enables the Popup alerts to occur on PCs when the PC is logged on, logged off or locked (the PC must be powered on). Operates on Windows Vista, 7, 8, and 10 (Not XP), No Sound or Image Files when logged off or locked. The license is a one time cost and is sold in batches of 100.

**The system includes 10 Licenses at No Charge.**

**LYNX-MSGPRO SFTWR,LYNX,MESSANGERPRO,100 CLIENTS LICENSES**



# Lynx System Outputs

## Automate Communication of Alarms

Take the Human Element out of Communication  
Improve Response Time and Awareness



SHOOTER  
DETECTION  
SYSTEMS

SOFTWARE HOUSE  
C-CURE 9000

Genetec



Sound Intelligence  
Aggressive Behavior Detection

KANTECH

### Communicate Dynamic Information to Security Radios and other Lynx Outputs

If you want to integrate existing duress and other alarms to communicate to Computers, Radios, Overhead PA systems, HDMI Monitors, IP Phones/Speakers, mobile phones or other devices you can simply integrate the existing alarms with the Lynx System. Using our supervised LynxNet Input Devices, SDS Integration, Lynx API, integration with Sound Intelligence for Aggressive Shouting or the C-CURE9000 SDK. Depending on the type of issue and location different groups may be notified.

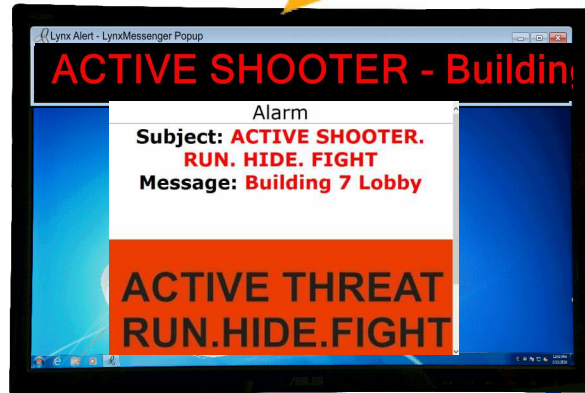
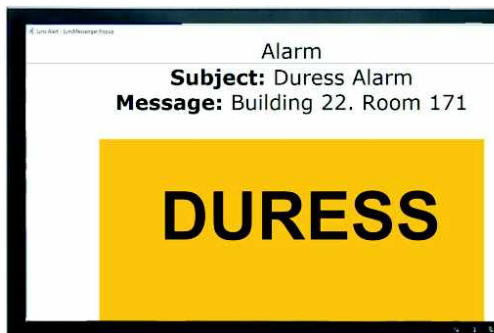
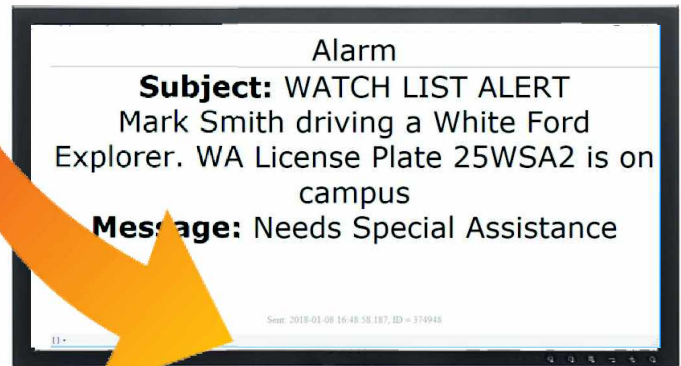
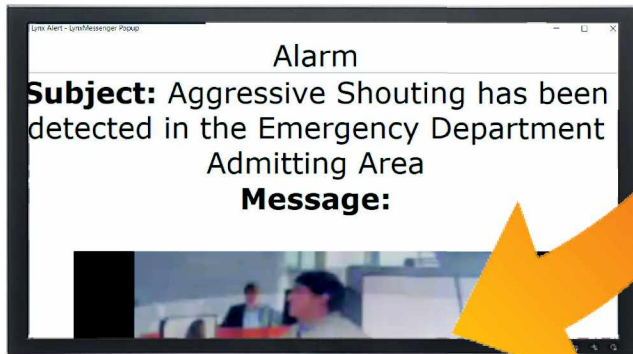

AXIS  
COMMUNICATIONS



SHOOTER  
DETECTION  
SYSTEMS

Active Shooter Detection Systems - Software Integration - **LYNX-SDS-1**



## Wireless Fixed or Mobile Duress with Location

**Monthly  
Test Feature**

When a wireless duress button is activated, a 900 Mhz signal is sent to the Lynx-WLS receiver. The wireless transmitters can be installed in fixed locations with the pre-determined alarm location message. Or the LYNX-WLS can triangulate the location of the wireless button using a repeater network. The receiver supports up to 500 wireless transmitters. The web interface of the Lynx-WLS displays the signal strength of every transmitter and repeater. Any of the wireless transmitters can be placed in a test mode, for employee training and monthly testing.



Compact wireless duress buttons with belt clip.

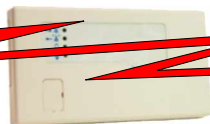

Low Voltage Repeater for locating or extending range.



Lynx-WLS

**900 Mhz Spread Spectrum Technology, not WiFi 802.11.**

- Fixed Wireless Duress Alarms - with alarm location.
- Mobile Wireless Duress Alarms - with alarm location.

### LYNX-WLS-3 Wireless Locating System for Fixed or Mobile devices

The Lynx-WLS connects to a network connection and power. The wireless duress buttons are pre-programmed to the Lynx-WLS either for fixed or mobile use applications. For Fixed applications a repeater is only needed approximately every 10,000 square feet, based on building structure. For Mobile locating applications a repeater is needed approximately every 1,500 to 2,000 square feet, based on building structure. See example diagrams below. The Locating system requires a Lynx Technician onsite to configure the system after the Lynx-WLS and repeater network are installed.

### "Mobile Duress Button: Mary Smith Behavioral Health Building Near Room 520"

Now when a mobile button is pressed the alarm goes out to PCs, Radios, Phones with the actual location  
With fixed location alarms the Building, Room, Name of the person and other information can be included

#### Fixed Location. 3 story building.

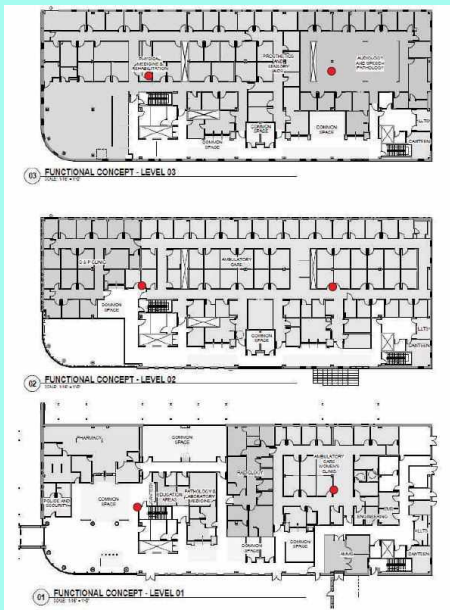

**1 LYNX-WLS, 6 Repeaters, 120 Buttons**

#### Mobile Locating System.

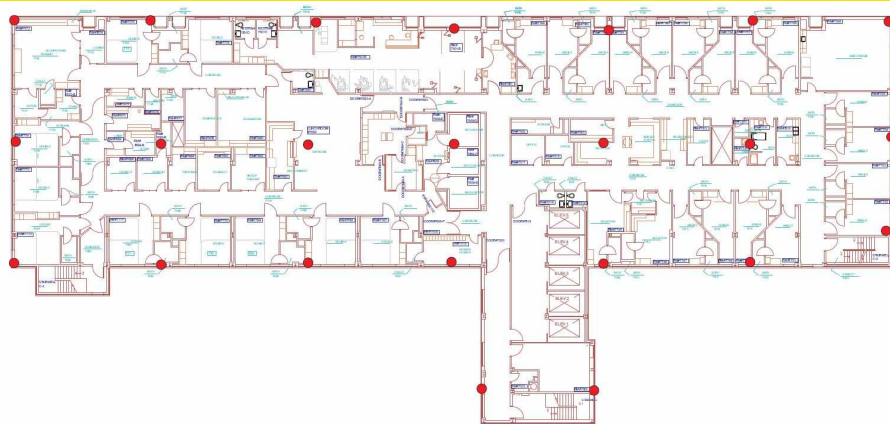

**1 LYNX-WLS, 23 Repeaters, 50 Buttons**

**Onsite Wireless Configuration is required for the Locating system once you have installed the hardware.**

**LYNX-WLS-1D  
LYNX-WLS-2D**

**CONFIG,LYNX WLS,1 DAY,ONSITE  
CONFIG,LYNX WLS,2 DAY,ONSITE**

The Lynx-WLS Mobile solution gives you the ability to have mobile wireless duress buttons in high risk areas that can locate the employee down to room accuracy. The notification is the fastest in the industry to response teams via computers, radios and other mobile device. The Lynx wireless mobile solution uses wireless 900 Mhz repeaters to locate to the alarm location. The repeaters are required every 40/50 feet in every direction.



# LYNX-WLS Wireless Alarm and Repeater Options

## Wireless supervised alarms are pre-configured to the Lynx-WLS

Fully Supervised - Low Battery Notification - Battery Life 1- 3 years.

The Lynx-WLS supports up to 500 unique transmitters.



**LYNX-WLT-PANIC-A** Simple, single-button activation pendant. Comes with a belt clip or can be easily mounted under a desk. Push and hold 2 seconds.



**LYNX-WLT-PANIC-B** Two-button activation, one channel pendant. Comes with a belt clip or can be easily mounted under a desk. Both buttons must be pressed to send alarm.

### Repeaters with Battery Backup



**LYNX-WLR-INDOOR** Indoor Repeater required for Locating system or increases the range of fixed transmitters. 14VAC Supervised by the Lynx-WLS Low voltage w/Battery backup Dims: 6.5" x 3.5" x 1"



**LYNX-WLR-OUTDOOR** Outdoor Repeater for expanded coverage. Supervised by the Lynx-WLS. Low Voltage w/Battery backup. 14VAC Dims: 7" x 7" x 3"

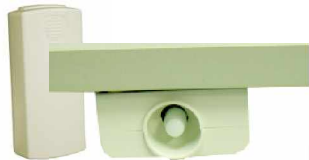

**LYNX-WLT-IDPNC-3** The momentary HUB Wireless Duress alarm is a supervised universal transmitter with a 6" wire connected to a HUB duress button.

**LYNX-WLT-IDPC-4** Locking



### LYNX-WLT-BILL-0

Wireless Bill Trap allows cashiers to covertly activate an alarm in a cash drawer, simply by removing the bill.



### Other Wireless Transmitters

**LYNX-WLT-PIR-1**

LYNX,WLT,PIR

**LYNX-WLT-DOOR-1**

LYNX,WLT,DOOR

**LYNX-WLT-UNIV-1**

LYNX,WLT,UNIVERSAL

**LYNX-WLT-TMPH-E**

LYNX,WLT,TEMP-RH,EXT SENSOR

OTHER TEMPERATURE SENSORS AVAILABLE

**Monthly Test Feature**

## Wireless Indoor Wall Mounted Buttons - Ideal for Codes.



**LYNX-WLT-IDPNC-2** The simple to install indoor wall mounted wireless button has a clear cover, custom text and color based on your application. It instantly sends a wireless alert to the Lynx-WLS receiver.

Available Hardwired PoE (Page 10)

Avail: Yellow, Blue, Red, White, Green Dims: 8.5" (H), 5.5" (W), 4.5" (D) 3lbs.



**LYNX-WLT-IDPNC-1** The indoor wall mounted wireless button is available without a cover. The color and text is customized. It instantly sends a wireless alert to the Lynx-WLS receiver.

Available Hardwired PoE (Page 10).

Avail: Yellow, Blue, Red, White, Green Dims: 5" (H), 4.5" (W), 3.3" (D) 1lbs.

## Wireless Outdoor Pole or Wall Mount Buttons



The battery powered **LYNX-WLT-ODPNC-3** large, visible outdoor wireless POLICE EMERGENCY BOX - Ideal for parking lots, garages and remote areas. Includes Enclosure Mounting Backplate, Pole Mounting Bracket w/Fasteners, Wall Mount Clips, Polycarbonate enclosure, Weatherproof Red Panic Button.

Very cost effective and easy to install.



**LYNX-WLT-MANDN-1** The "Mandown button" sends out a duress alarm through the LYNX-WLS if the button is pressed. If the unit is not vertical, it beeps for 30 seconds to alert the employee to correct it. If not, it sends out a "Mandown" alarm - possibly for medical assistance. It instantly sends a wireless alert to the Lynx-WLS receiver.



### LYNX-MON-0 Wireless Monitor

The Wireless Monitor was designed to operate either as a standalone wireless solution or as part of the Lynx system. It is ideal for locations such as Clinics and off sites that need to receive local alarms.

# Optional Inputs

# Duress Buttons, Tie into existing alarms

## LynxUSB V10 USB Hardwired Duress Buttons



Operates when  
PC is logged off

The LynxUSB allows you to install a hardwired duress button on a Windows based PC connected to your network. Alerts are sent to the LynxGuide server even when the PC is logged off. The new monthly test enables the employees to test the button, building confidence and creates a report for security.



Supervised

Supervision awareness for employees Operational Non Operational

**Monthly  
Test Feature**

**LYNX-USB-0**

USB Hardwired Duress Button

**LYNX-USB-L**

USB Hardwired Duress Button - Locking

## LynxNETPB

## Network Hardwired Duress Button (No PC required)



Supervised

The LynxNetPB is a network duress device, that when activated instantly sends an alert to the LynxGuide server via your network. The LYNX-NETPB-M (PP PoE) has a momentary panic button and a locking version is available. The duress button attaches with an 8 foot cable. Available 12VDC or PoE. The monthly test enables the employees to test the button, building confidence and creates a report for security.

**LYNX-N-PB-M**

Network 12VDC with HUB style Duress Button

**LYNX-N-PP-M**

Network PoE with HUB style Duress Button

**Monthly  
Test Feature**



PoE Wall Mounted

The network wall mounted button with (or without) a cover connects directly to the network via the LynxNetPP device. The green LED indicates connectivity. Custom color and text are available. The duress button attaches with an 8 foot cable.

**LYNX-N-PP-WWC**

Network PoE, Custom Wall Mounted Button with Cover

**LYNX-N-PP-WNC**

Network PoE, Custom Wall Mounted Button with No Cover

## LynxNET

## Tie into existing alarms anywhere on your network



32-128 Inputs

The LynxNeti series input devices are ideal for applications where existing duress systems need updating or large numbers of points need to be monitored. Existing duress buttons and wiring can be used with the LynxNeti series to allow the alarms to be sent to the LynxGuide server.

The LynxNeti series devices can instantly send alerts from any of the dry contact closure inputs. Inputs are programmable "Normally Opened" or "Normally Closed". Wire integrity to the end point of the inputs, can be supervised using supplied EOL resistors. The test feature makes it easy to test alarms and create monthly reports.

**LynxNet 128i series Dimensions: 18" (H), 12" (W), 4" (D) Wt: 17.5lbs**

**Monthly  
Test Feature**

**LYNX-4i-3**

4 Channel

**LYNX-32i-3**

32 Channel

**LYNX-64i-3**

64 Channel

**LYNX-96i-3**

96 Channel

**LYNX-128i-3**

128 Channel



1 or 4 Inputs



The LynxNet 32-128 use easy to install connectors that are removable to make wiring easy.

**API - LYNX-API-1 SFTWR,LYNX,API,ONE CONNECTION LICENSE**

## Indoor IP 3 Color Situation Status Light

## LynxStrobe-C

The **LynxStrb-C** provides 3 color visual notification from a single strobe. The strobe can be programmed to be **GREEN**, **AMBER** or **RED**, constantly on or flashing. The LED strobe flashing speed is programmable.



**LYNX-STRB-C**

Lynx Indoor Light, Network, **GREEN**, **AMBER**, **RED**

## Indoor 4 Color IP Strobe with built in audible tone

## LynxStrobe-1

The **LynxStrobe** provides visual notification with audible tone. The four colors **RED**, **YELLOW**, **Green**, **Blue** strobe is ideal for lobbies, classrooms and other public areas. The LynxStrobe master can have up to 3 additional remote strobes connected within 100 feet.



**Dimensions**

13" (L), 4 1/8" (W), 3 3/4" (D)



**LYNX-STRB-1**

4 Color IP Strobe Network Master Strobe

**LYNX-STRB-2**

4 Color Remote Strobe (Requires **LYNX-STRB-1**)

## IP Strobe

## LynxStrobe

The Indoor **LynxStrobeA** provides a single **Blue** visual notification, ideal for lobbies, classrooms and other public areas. Remote single strobe can be activated by any of the software or hardware alarms.

Strobe Dimensions: 2 1/4" (L), 4" (W), 2" (D)

**LYNX-STRB-A**

Lynx Indoor Strobe, Blue, 50 ft cable, Network Interface

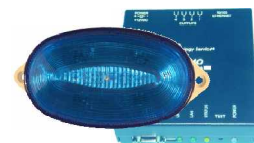

The **LynxStrobeB** provides a single **RED** visual notification with built in loud 122 dB Siren. Install indoors or outdoors.

Strobe Dimensions: 2 1/4" (L), 4" (W), 2" (D)

**LYNX-STRB-B**

Lynx Outdoor Strobe, Red, 50 ft cable, Network Interface



## LED Sign

## LynxSIGN

The **LynxSign** is an indoor LED text display that displays messages from the LynxGuide server.

The larger -2 and -3 are for use indoor or outdoor.



**LYNX-SIGN-1**

LYNX,LED SIGN, 31" X 6", INDOOR

**LYNX-SIGN-2**

LYNX,SIGN,LED, 41" X 11", OUTDOOR

**LYNX-SIGN-3**

LYNX,SIGN,LED, 66" X 11", OUTDOOR

The LED sign has a built in audible tone

We just finished converting the Security Department at Community Hospital Anderson over to a Hospital Police Department and wanted to share a photo of one of our patrol vehicles which we have added the decals showing Press F9 & F11 for a Campus Emergency on the sides and rear tailgate of both patrol vehicles. This has been well received by our employees and they also like the 16 Lynx Emergency Call Boxes that we just installed at all Campus locations with the assistance of KST out of Indianapolis. Again wanted to say thank you very much for introducing me to such a great safety product that you have to offer with your Lynx Systems.





# Optional Outputs

## Verbal, Visual and Output Notifications

*The Lynx System enables you to reduce the human element of communication during an event, improving response times and eliminating mistakes.*

### LynxDispatcher

### Lynx Radio Verbal Notification Output

The LynxDispatcher allows instant Radio broadcast of alert messages using your existing radio system.



The **LynxDispatcher** allows any of your Lynx alarms to communicate to your existing radio system. The messages can be pre-recorded wave files or use the built-in text to speech feature. The text to speech feature allows for variable data to be verbalized in real time. The LynxDispatcher will broadcast on the one channel and frequency on a hand held radio you supply. More than one LynxDispatcher may be used to cover multiple radio frequencies and channels.

**Wall mounted Rugged Metal House. Dimensions 6 3/4"(W), 17 1/2" (w/o antenna) (H), 3" (D)**

**LYNX-DISP-3**

LynxNet Radio Interface Customer Supplied Radio

The LynxDispatcher requires you to supply one of YOUR radios for permanent installation

### LynxPA

### Interface to your existing PA system



The **LynxPA** allows any of your Lynx alarms to communicate to your existing PA system. The messages can be pre-recorded wave files or use the built-in text to speech feature. The text to speech feature allows for variable data to be verbalized in real time.

**LYNX-PA-3**

LynxPA Audio output device

The audio output can be connected to your existing PA system(s) or any other systems that accept line level audio such as Outdoor Speaker arrays.

### LynxNET40-640

### 4 - 64 Channel Output device



The **LynxNetO** series output device has relay outputs that are controlled by the LynxGuide server. Standard configuration is "Normally Opened" and optionally can be ordered as "Normally Closed". The **LynxNetO** series output devices are ideal for connecting into access control systems or connecting into monitored alarm panels to contact law enforcement or other responding agencies.

**LYNX-40-31**

4 Channel Hardwired, 8 amp Relay, Output device

**LYNX-160-31**

16 Channel Hardwired, 8 amp Relay, Output device

**LYNX-320-31**

32 Channel Hardwired, 8 amp Relay, Output device

**LYNX-480-31**

48 Channel Hardwired, 8 amp Relay, Output device

**LYNX-640-31**

64 Channel Hardwired, 8 amp Relay, Output device



The 8 amp power relay model allows direct control of devices requiring power to be switched for activation. The 1 amp relay model has gold relay contacts to allow control of low voltage devices that require a dry contact closure.

For 1 amp Relay use part # LYNX-XXX-32

LynxNet 640 series Dims: 18" (H), 12" (W), 4" (D) Wt: 17.5lbs



**LYNX-C-SDK**

**LYNX,CCURE,SDK,INTERFACE**

# LynxGuide Server Configurations

The **LynxGuide** Server is available as a turn-key server or software only to be installed on the customer supplied server or in the customer supplied virtual machines. The Standard Single site solution is available with 2,000 client seats up to 20,000 client seats. Each client software function is counted as one server seat. **One computer with LynxCliant installed can use 1-4 server seats, depending on what LynxCliant functions are enabled.** Any LynxNet device is counted as one server seat. LynxGuide Standard software licensing allows for a server to operate on a LAN covering a single campus or facility,(including remote offices with less than 100 PCs within the county).

## Standard LynxGuide Server configurations - 2,000 - 20,000 Client seats



**LYNXS-SSD-02** LYNX,STD SVR,SSD,2,000 SEATS,100 LKP,10LMP,10 IP  
**LYNXS-SSD-05** LYNX,STD SVR,SSD,5,000 SEATS,200 LKP,10LMP,10 IP  
**LYNXS-SSD-10** LYNX,STD SVR,SSD,10,000 SEATS,400 LKP,10LMP,10 IP  
**LYNXS-SSD-20** LYNX,STD SVR,SSD,20,000 SEATS,800 LKP,10LMP,10 IP

Part Number	LYNXS-SSD-02	LYNXS-SSD-05	LYNXS-SSD-10	LYNXS-SSD-20
License Type	Standard - Single site	Standard - Single site	Standard - Single site	Standard - Single site
Server Seats	2,000	5,000	10,000	20,000
LynxKeyPro included	100 seats included	200 seats included	400 seats included	800 seats included
Server Type	Dell PowerEdge OEM	Dell PowerEdge OEM	Dell PowerEdge OEM	Dell PowerEdge OEM
Form Factor	1U with ReadyRails	1U with ReadyRails	1U with ReadyRails	1U with ReadyRails
CPU	Dual 8-Core, 8 Threads	Dual 8-Core, 16 Threads	Dual 8-Core, 16 Threads	Dual 8-Core, 16 Threads
RAM	16GB	16GB	16GB	16GB
Raid Type	RAID 1, 2 GB Cache	RAID 10, 2 GB Cache	RAID 10, 2 GB Cache	RAID 10, 2 GB Cache
Number of Drives	Two (2)	Four (4)	Four (4)	Four (4)
Hard Drive Type	400 GB, SSD SATA	200 GB, SSD SATA	200 GB, SSD SATA	200 GB, SSD SATA
Power Supply	550 W, Dual/Redundant	550 W, Dual/Redundant	550 W, Dual/Redundant	550 W, Dual/Redundant
Windows OS	2016 Standard, 64-bit	2016 Standard, 64-bit	2016 Standard, 64-bit	2016 Standard, 64-bit
Hardware Warranty	3 Year ProSupport from Dell	3 Year ProSupport from Dell	3 Year ProSupport from Dell	3 Year ProSupport from Dell

## LynxGuide - Server Software Only for Virtual Machines

The **LynxGuide** server software is available for installation on customer supplied servers. The server should meet the above specification and have the operating system software installed. The **LynxGuide** server software is available for Virtual Machines, see specifications below

**LYNXS-SW-1C** LYNX,STD SW, NO OS,100 SEATS,10LMP,NO LKP OR IP  
**LYNXS-SW-02** LYNX,STD SW, NO OS,2,000 SEATS,100 LKP,10 LMP,10 IP  
**LYNXS-SW-05** LYNX,STD SW, NO OS,5,000 SEATS,200 LKP,10 LMP,10 IP  
**LYNXS-SW-10** LYNX,STD SW, NO OS,10,000 SEATS,400 LKP,10 LMP,10 IP  
**LYNXS-SW-20** LYNX,STD SW, NO OS,20,000 SEATS,800 LKP,10 LMP,10 IP

Part Number	LYNXS-SW-1C	LYNXS-SW-02	LYNXS-SW-05	LYNXS-SW-10	LYNXS-SW-20
License Type	Standard - Single site	Standard - Single site	Standard - Single site	Standard - Single site	Standard - Single site
Configuration	Dedicated VM	Dedicated VM	Dedicated VM	Dedicated VM	Dedicated VM
Server Seats	100	2,000	5,000	10,000	20,000
LynxKeyPro included	0	100 seats included	200 seats included	400 seats included	800 seats included
Read IOPS / Latency	700 Average / <3.5ms	700 Average / <3.5ms	700 Average / <3.5ms	700 Average / <3.5ms	700 Average / <3.5ms
Write IOPS / Latency	160 Average / <10ms	160 Average / <10ms	160 Average / <10ms	160 Average / <10ms	160 Average / <10ms
HDD size	80 GB	100 GB	120 GB	140 GB	200 GB
RAM	3 GB	8GB	16GB	16GB	24GB
# of CPU Cores	Two (2)	Eight (8)	Twelve (12)	Twelve (12)	Twelve (12)
Windows OS	2016 Standard, 64-bit	2016 Standard, 64-bit	2016 Standard, 64-bit	2016 Standard, 64-bit	2016 Standard, 64-bit
Enabled Features	.Net Framework 4.5	.Net Framework 4.5	.Net Framework 4.5	.Net Framework 4.5	.Net Framework 4.5

**Enterprise multi-site solution license is available**

# IT Information - Frequently Asked Questions about LYNX

The **LynxGuide** Server is available as turn-key server with the LynxGuide software pre-installed on a Dell OEM server, configured and quality tested for quick installation on your LAN. The **LynxGuide** server software is available for customer supplied servers or virtual machines. The LynxGuide system is typically operated by the security department, but the IT's role is critical for deployment of the system.

**LynxGuide Standard Software License** allows the customer the right to use the software at a single campus or facility including remote offices with less than 100 PCs within the county. Separate facilities with more than 100 PCs require a LynxGuide server per facility or an Enterprise, multi-site solution.

**Ports** The LynxGuide server needs inbound ports 80 or 443, 10117, 10118, 10119, 10120 and 10121 opened. LynxNet devices needs TCP ports 80, 443, 10119 and 10121 opened.

**Security** The Lynx system supports encryption of all data transfer over the LAN and WAN. Both the LynxClient software and LynxNet hardware support the TLS 1.2 protocol for their connection to and from the LynxGuide server. The LynxGuide web interface supports HTTPS for all access to management and reporting functionality. The Lynx system includes the ability to enable FIPS 140-2 compliance mode.

**Outbound Communication** For LynxSMS and LynxVoice Plans the LynxGuide server must be able to connect to <http://sms1.mitsi.com> and <http://sms2.mitsi.com> on port 80 or 443.

**E-mail** LynxGuide has the ability to relay email through a customer's mail server.

**Active Directory** System operators can Login to the Lynx Server web interface using their AD credentials or with siglne sign on

**Virus Scanning** Virus scanners can be installed on the LynxGuide Server.

**Database** The LynxGuide Server includes a local instance of Microsoft SQL Server Express, but customer's Microsoft SQL version can be used. Remote DBs can be supported, however if the LynxGuide server can not connect to the remote DB, no alarms will be processed.

**Supervision** LynxClient and LynxNet devices check-in with the LynxGuide Server every 5 minute by default. Supervision packet are less than 1Kb.

**LynxClient Software Installation** LynxClient is a 5.5 Mb MSI and can be manually installed or distributed using your software distribution tools. LynxClient can be deployed in a dormant mode, for remote activation later.

**Location Information for LynxClient software** The information for determining the location of the computer that launched a Lynx alarm is stored on the LynxGuide server. Each client workstation uses the computer name as the unique identifier. The LynxGuide server uses a lookup table to translate the unique identifier into useful location information. This information can be uploaded to the Lynx system via a .CSV file.

The LynxClient test feature allows for users to provide the initial data or verify the stored data as part of the monthly test. When users provide information, it is presented in an administration level panel, to verify before updating the location lookup table. This updated location data is exportable to share with IT.

**Failover Configuration** The Lynx system may be set up in a Failover configuration. This will require two LynxGuide servers, load balancer(s) and a Failover package. Contact Sales for more details.

<b>LYNX-FO-WSQ</b>	<b>SFTWR,LYNX,FAILOVER,UPGRADE,WITH SQL with Single Load Balancer</b>
<b>LYNX-FO-DLB</b>	<b>SFTWR,LYNX,FAILOVER,UPGRADE,WITH SQL with Dual Load Balancer</b>
<b>LYNX-FO-SWO</b>	<b>SFTWR,LYNX,FAILOVER,SOFTWARE ONLY</b>

**Technical Questions: (972) 231-6874 Ext 131 or email [KEVIN@MITSI.COM](mailto:KEVIN@MITSI.COM)**

**A customer's comment after working with a Lynx Technical Support technician:**

*I really appreciate his help and just wanted you to know that his customer service was absolutely Top Notch! If I could clone a few of him and have them work for me I would have no worries!* **Large Government facility in Arizona**



# Lynx System Phone, SMS, Training and Support

## Optional SIP Trunking Interface for IP Phones

## LynxVOIP

The LynxVOIP plugin allows verbal messages to be sent to IP Phone systems that support SIP trunking protocol. The LynxVOIP plugin dials an extension, call group or paging groups that are configured in your IP Phone system.

**LYNX-IP-INT-0**

LYNX,IP PHONE INTERFACE No annual or per user fees



## Optional Yearly Verbal Phone calling

## LynxVoicePlan

The LynxVoicePlan allows you to send verbal text-to-speech messages to specific USA 10 digit phone numbers, when an alarm is activated. Each telephone number called is a minimum of 1 minute.

**Plans are for 12 Months. Note: 911 Call Centers do not accept automated calls**

**LYNX-VP-1K**

VOICE PLAN, 1,000 PLAN, Minutes Per Year

**LYNX-VP-2K**

VOICE PLAN, 2,000 PLAN, Minutes Per Year

**LYNX-VP-5K**

VOICE PLAN, 5,000 PLAN, Minutes Per Year

**LYNX-VP-10K**

VOICE PLAN, 10,000 PLAN, Minutes Per Year

**LYNX-VP-20K**

VOICE PLAN, 20,000 PLAN, Minutes Per Year



## Optional Yearly SMS text messaging

## LynxSMSPlan

LynxSMSPlan allows the Lynx system to send large scale SMS messages to USA cell phones. The LynxGuide server's built in subscription page allows employees or students to subscribe to receive text notification. SMS credits are pre-purchased, applied to customers account and deducted when SMS messages are sent. **Plans are for 12 Months.**

**LYNX-SMS10K**

SMS-PRO,10,000 PLAN, SMS Per Year

**LYNX-SMS25K**

SMS-PRO,25,000 PLAN, SMS Per Year

**LYNX-SMS50K**

SMS-PRO,50,000 PLAN, SMS Per Year

**LYNX-SMS100K**

SMS-PRO,100,000 PLAN, SMS Per Year

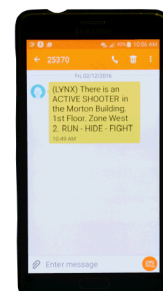

## Optional LYNX On-site Training and Online Remote Services

Lynx support technician will arrive on site to provide training for Lynx administrators, Lynx owners and IT. The training covers configuration and management of the Lynx system, software and hardware. Training is scheduled 4-6 weeks after the pilot deployment is completed. **Price includes all travel related costs within the USA.**

**LYNX-TRN-1D**

One day On-site Training

**LYNX-TRN-2D**

Two days On-site Training

Many deployments do not require an onsite Lynx support technician. Lynx provides remote training for Lynx administrators, Lynx owners and IT remotely. The remote training covers configuration and management of the Lynx system, software and hardware.

**LYNX-REMT-A**

SERVICES,LYNX,REMOTE - A

**LYNX-REMT-B**

SERVICES,LYNX,REMOTE - B

## Lynx System Yearly Support and Software Updates

**LYNXS-SSA-1** SSA, STANDARD SERVER LYNX SUPPORT, 1 YEAR

Lynx system includes the 1st year of support and software updates. Purchase up to 3 years in advance

**Support includes:**

Telephone Support, Monday - Friday, 8:00am – 5:00pm Central Time

Emergency after hours phone support

Product software updates

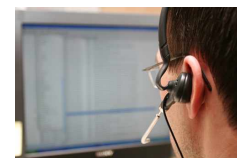

# HDMI Monitor Popup Alerts and Axis IP Speakers

## LynxNetMessenger



The **LynxNetMessenger** is useful for locations that do not have PCs or the PCs may be turned off, such as conference rooms or classrooms.

The **LynxNetMessenger** can operate in a stand alone mode where an uploaded image may be displayed until a notification is sent. It can also be configured for a pass through mode, where a HDMI feed passes through the **LynxNetMessenger** until a notification is sent. The **LYNX-NETM-2** has a local reset button to clear the first message in manned locations.

**LYNX-NETM-1**  
**LYNX-NETM-2**

**LYNX,NETWORK,MESSENGER**  
**LYNX,NETWORK,MESSENGER,USB RESET**

## Network Monitor "Popup" Alerts

The **LynxNetMessenger** allows Lynx notifications to be sent to HDMI Monitors when there is an event. Each monitor can be sent messages and/or instructions based upon location. The speakers on the Monitor can communicate verbal messages.

**Simplify your Emergency Instructions in Public Areas**



## Lynx-Axis PoE IP Speaker Integration for verbal communication



The Lynx-Axis IP Speaker integration communicates to AXIS PoE IP speakers, using your facilities network. The messages may be text-to-speech or pre-recorded messages. Messages can be sent to one or all speakers. The messages are logged within the Lynx message log and confirmation that the message was played.

### Lynx-Axis integration features:

- Fully Supervised
- Audio Synchronization with multiple speakers
- Text-to-speech or pre-recorded messages
- Activate from any Lynx Input
- Confirmation and logging of communication

**LYNX-AXIS-I**  
**LYNX-AXIS-S**

**SFTWR,LYNX,AXIS,IP SPEAKER,INTEGRATION,REQUIRED**  
**SFTWR,LYNX,AXIS SPEAKER,ONE CONNECTION LICENSE (Add 1 per speaker)**